

1

2

3

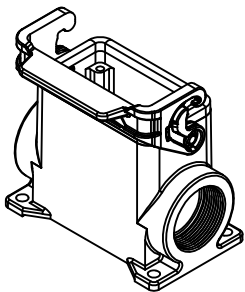
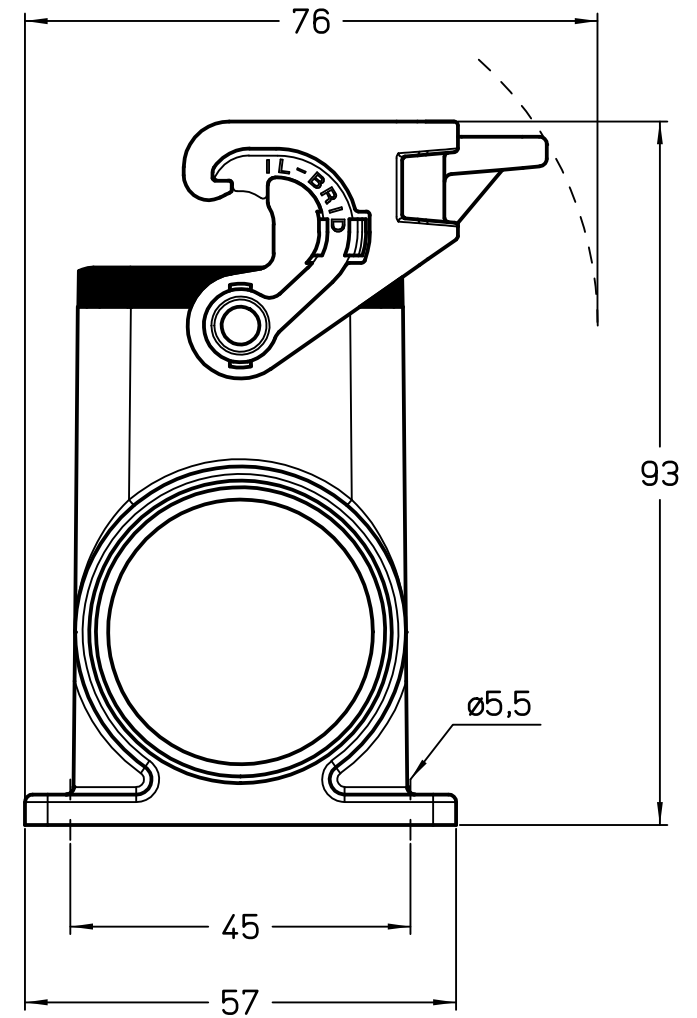
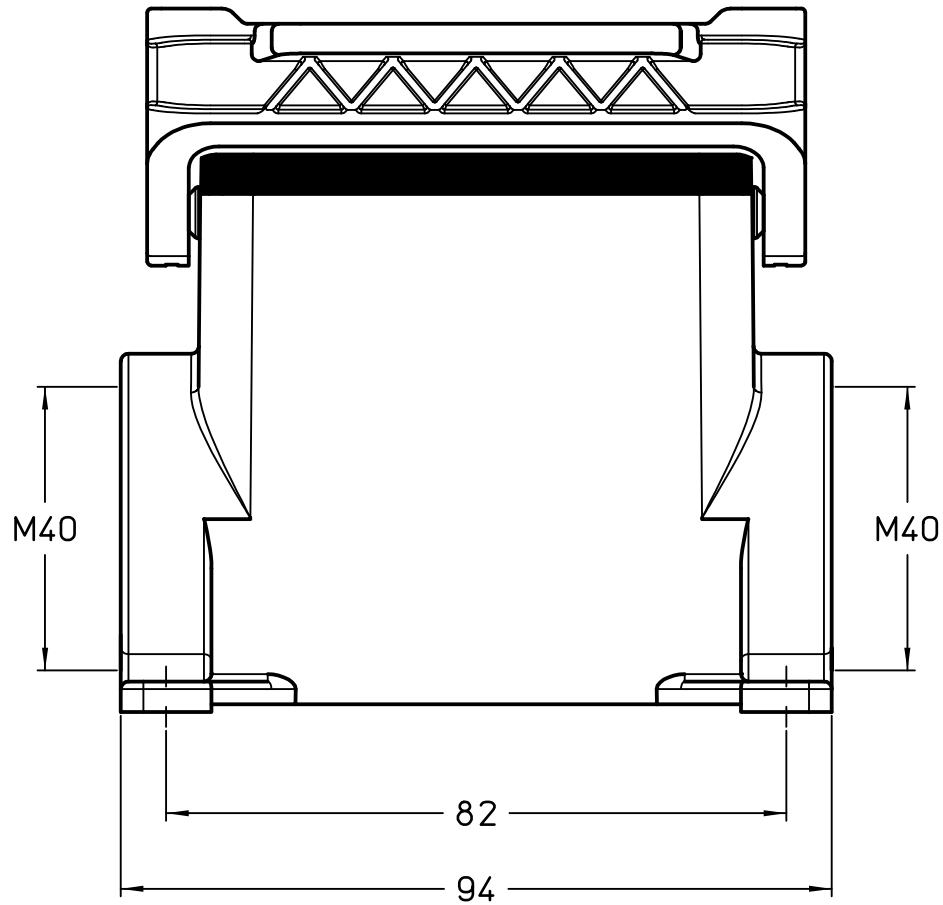

	Dimensions in mm
Original Size A4	
Date 09/03/23	
Sign. G. Renna	

Simplified representation with dimensions without tolerance

MLAP 10 L240
surface mounting housing, size "57.27", high construction, 2xM40 side entries,
with 1 IL-BRID lever

Scale
1:1



1

2

3